

A Brief History of Beckwith Township

The Township of Beckwith was surveyed in 1816 and the first major influx of settlers starting in 1818.

The Township was named after Sir Thomas Sydney Beckwith (born in 1772 and died in 1831). Sir Sydney Beckwith was the Quarter Master General for Canada between 1815 and 1823.

By the 1860's Beckwith's population was 2,629 which included Villages with schools, churches, blacksmith shops, cobblers, tailors, coopers, taverns, general stores, etc.

In 2016 Beckwith's population was 7,644 made up of those "Proud of their past and confident in the Future".

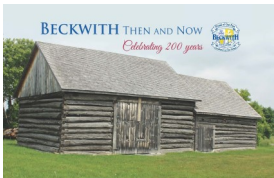

Beckwith

Then and Now

Beckwith Then and Now is a keepsake book containing historical stories, facts, recipes and photos of the people who helped create the modern day *Beckwith in the Bushes*. Books can be purchased at the Beckwith Township Office for \$45.10 (HST included).

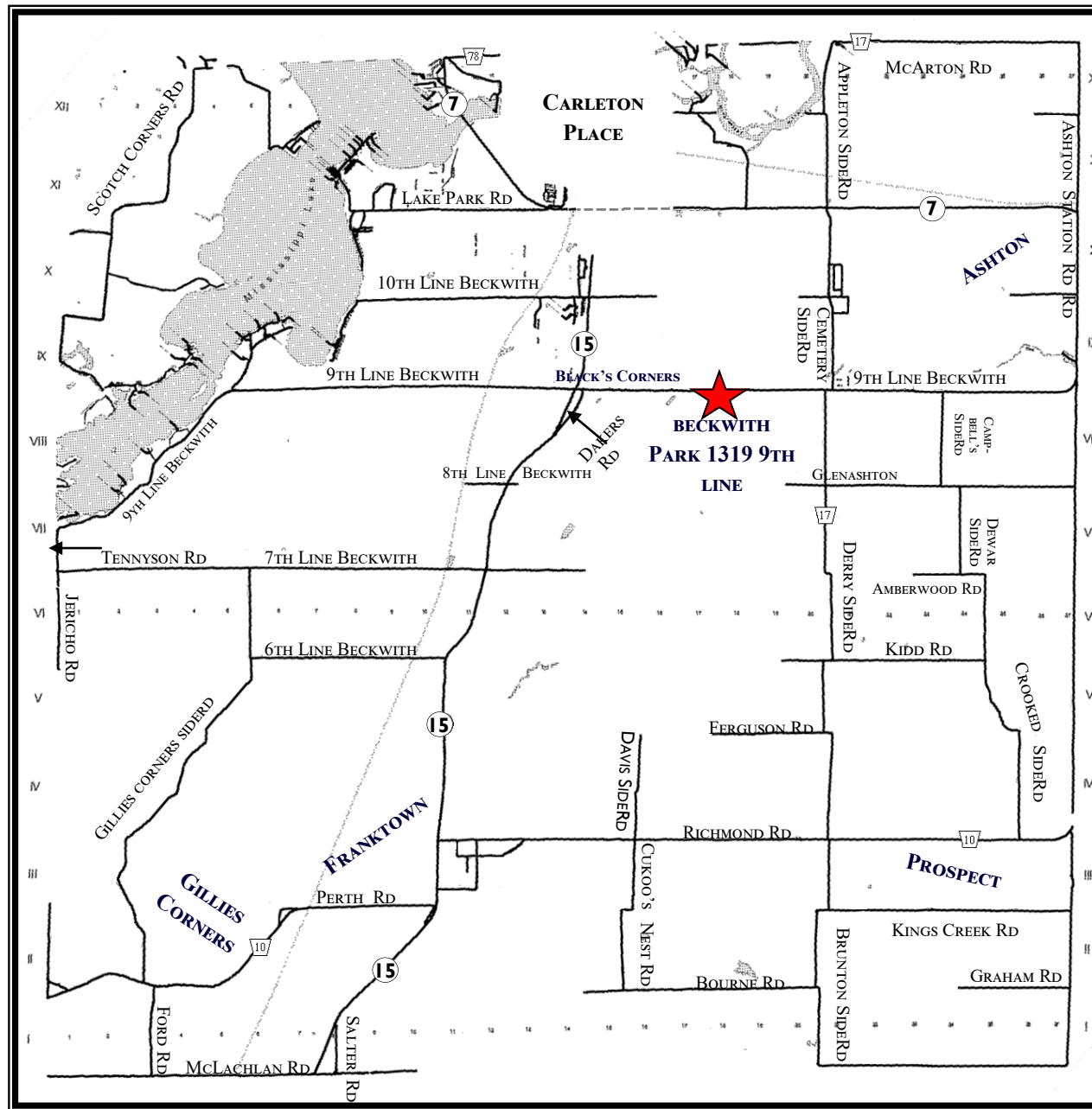

Historical Cemeteries of Beckwith Township

- | | |
|--|------------------------------------|
| 1. Beckwith United Cemetery - St. Fillan's | 6. Prospect United Church Cemetery |
| 2. Beckwith United Cemetery - Pinegrove | 7. St. Augustine's Anglican Church |
| 3. Beckwith United Cemetery - Maplewood | 8. Franktown Public Cemetery |
| 4. Kennedy Cemetery | 9. St. Mary's R.C. Cemetery |
| 5. Dewar Cemetery | 10. Sinclair Pioneer Cemetery |

This Brochure developed by

The Beckwith Heritage Committee

Date Published: Day Month Year



For More Information

[Beckwith Historical Interactive Map](#)

The Beckwith Heritage Committee has developed an Historical Interactive Map on the history of the Township of Beckwith. Please consult our website www.twp.beckwith.on.ca under Community—History— Beckwith Historical Map.

[Beckwith Book](#)

An extensive history of the Township of Beckwith was published in 1991 by Glen J. Lockwood *Beckwith: Irish and Scottish Identities in a Canadian Community*. Copies are on display and available for sale in the Township Office reception area at the price of \$45.53 (GST included).

If you have information or pictures in relation to any of the locations which you would like to contribute to our interactive map, please contact the Township Office at 613-257-1539.